

Repair Parts Sheet	Revision	Revision Date	Product Code Beginning
Reference nr. L2818	Rev.A	04/2009	O

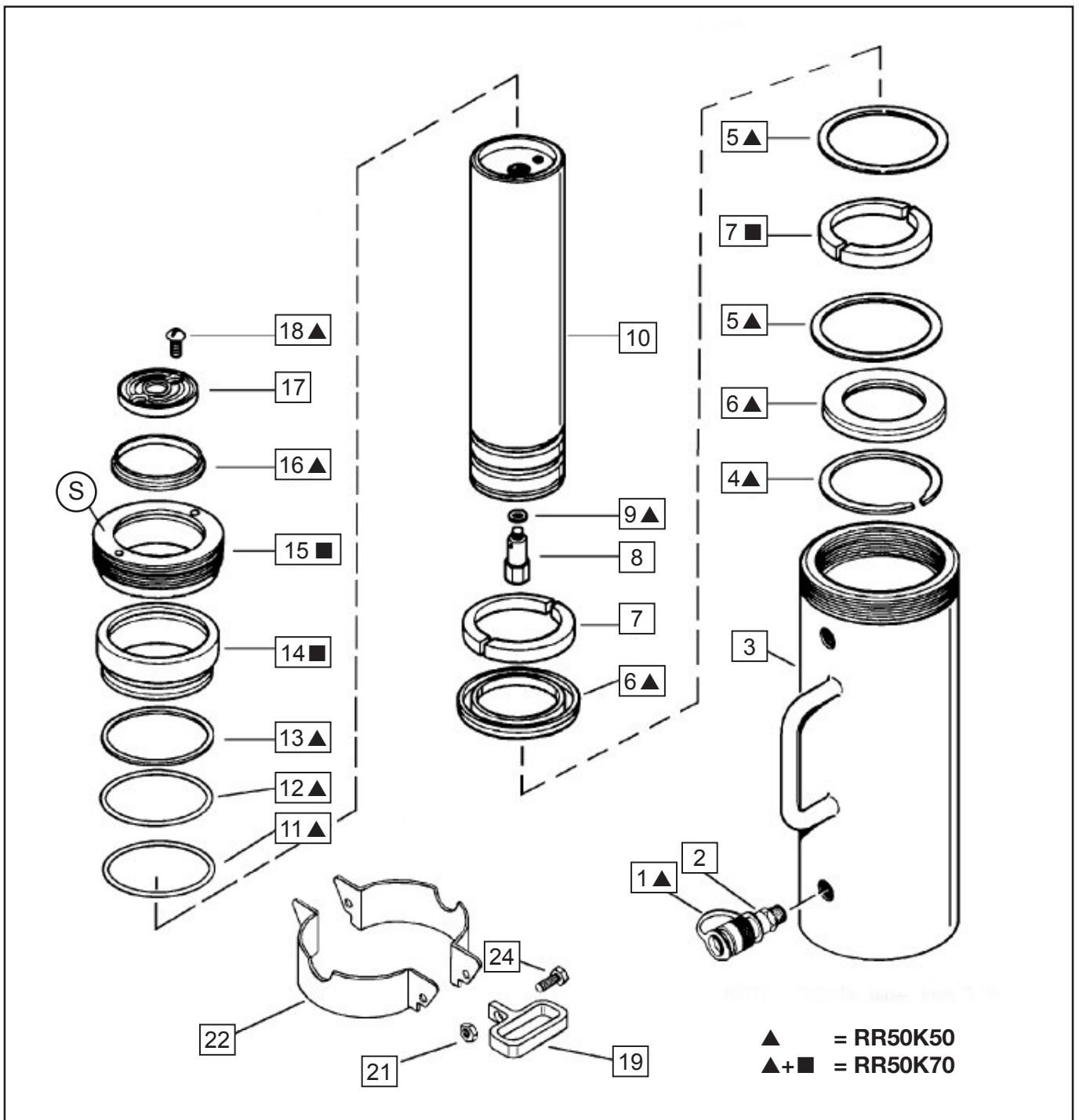

Repair Parts List

L 2818

Item	Description	Qty	RR506	RR5013
1	Dust Cap	2	▲	▲
2	Coupler	2	CR400	CR400
3	Cylinder	1	Not available as service item. Order new cylinder	
4	Retaining Ring	1	▲	▲
5	Washer	2	▲	▲
6	U Cup	2	▲	▲
7	Rod Bearing	2	■	■
8	Relief Valve	1	CR211900SR	CR211900SR
9	Gasket	1	▲	▲
10	Plunger	1	M23040	M24040
11	O Ring	1	▲	▲
12	O Ring	1	▲	▲
13	Back up Washer	1	▲	▲
14	Stop Ring	1	■	■
15	Internal Stop Ring	1	■	■
16	Wiper	1	▲	▲
17	Saddle (incl. 2x item 18)	1	L345045SR	L345045SR
18	Screws	2	▲	▲
19	Cylinder Handle (incl. item 21,24)	2		DA5184070SR
21	Hex Nut	2		
22	Collar (incl. item 19, 21,24)	2		CL1052950SR
24	Bolt	2		
25	Thread Protector (not shown)	1	▲	▲
26	Coupler O Rings (not shown)	2	▲	▲
27	Enerpac Decal (not shown)	2	▲	▲
28	Warning Decal (not shown)	1	▲	▲

- ▲ = Items included in and available only as part of Repair Kit RR50K50 (For Viton order RR5013KV)
 ▲+■ = Items included in and available only as part of Repair Kit RR50K70 (RR50K70 includes RR50K50)



Item	Torque / Remarks
2	34 - 81 Nm 25 - 60 ft lbs
2	Use Teflon tape or Loctite 545
5	Install washer 5 with chamfer facing 7 and square edge to item 6
8	Torque 6.8 - 7.9 Nm 60 - 70 in lbs
8	Safety valve setting 448 - 483 Bar
15	Secure with Loctite 222



To maintain your warranty,
 have your products inspected and repaired
 by an authorised Enerpac Service Centre

www.enerpac.com